

J:\PROJECTS\2024\0708-CENTRAL BOOKING RELOCATION\5-21-DWG\areaA2024.1101.dwg (Area A) 2/24/2024

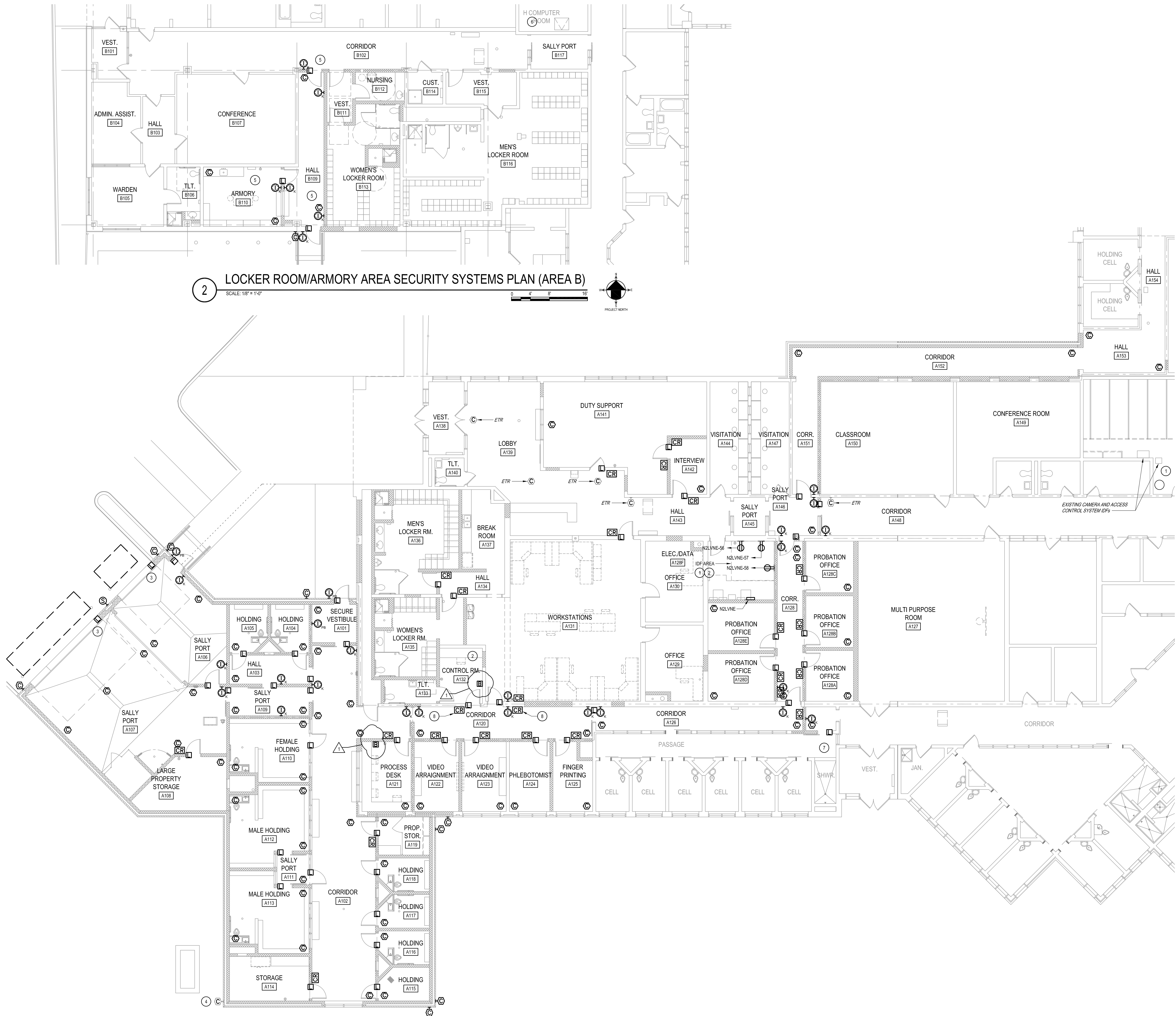

1 CENTRAL BOOKING AREA SECURITY SYSTEMS PLAN (AREA A)  
SCALE: 1/8" = 1'-0"

## GENERAL NOTES

- FOR CARD READERS, DOOR CONTROLS, OTHER ACCESS CONTROL DEVICES, AND SECURITY CAMERAS, CONTRACTOR SHALL INSTALL DEDICATED PATHWAYS TO EACH DEVICE LOCATION SHOWN ON THIS PLAN FOR USE BY COUNTY'S SECURITY AND ACCESS CONTROL VENDORS(S). VENDORS(S) WILL PROVIDE CABLING, TERMINATIONS, DEVICES, IDF RACKS AND EQUIPMENT, CONTROL WORKSTATIONS AND SCREENS, TESTING, AND COMMISSIONING. ALL PATHWAYS SHALL BE ROUTED TO ELEC/DATA A128F UNO FOR THE ARMORY AREA.
- VENDOR(S) ARE RESPONSIBLE FOR SYSTEM PROGRAMMING AND CONFIGURATION TO ACHIEVE DOOR CONTROL AND VIDEO MONITORING. THIS INCLUDES CONFIGURATIONS OF INTERLOCKING SCHEMES, OVERHEAD DOOR CONTROL METHODS, CAMERA ACTIVATION, WORKSTATION CONTROL, PRISON CENTRAL CONTROL OVERRIDES, ETC.
- DOORS SHOWN TO HAVE ELECTRIC LOCKING MECHANISM WITHOUT A CARD READER ARE TO BE CONTROLLED FROM THE CENTRAL BOOKING CONTROL ROOM WORKSTATION UNO. ELECTRIC LOCK SYMBOL REPRESENTS ELECTRICAL ACTUATION ON SLIDING DOORS.
- COORDINATE CEILING MOUNTED WORK WITH THE ARCHITECTURAL PLANS AND OTHER TRADES BEFORE PROCEEDING WITH ANY WORK. WHERE CONFLICTS OCCUR, NOTIFY THE ARCHITECT.

## KEY NOTES

- CONTRACTOR SHALL PROVIDE PATHWAY FROM EXISTING IDFS IN LOCATION SHOWN TO ELEC/DATA A128F FOR VENDOR USE TO CONNECT NEW IDFS INTO EXISTING PRISON SYSTEMS. PROVIDE (2) 2" CONDUITS AT A MINIMUM.
- CONTRACTOR SHALL PROVIDE DEDICATED PATHWAY FROM WORKSTATION LOCATIONS IN CENTRAL BOOKING CONTROL ROOM TO SECURITY AND ACCESS CONTROL HEAD END SYSTEMS WITHIN IDFS LOCATED IN ELEC/DATA A128F.
- PROVIDE CONNECTION FROM EACH POWERED OVERHEAD DOOR CONTROLLER TO CENTRAL BOOKING CONTROL SYSTEM PANEL. PROVIDE MANUFACTURER'S RECOMMENDED CONTROL OR COMMUNICATION CABLING IN APPROPRIATELY SIZED CONDUIT.
- RELOCATED CAMERA, SEE E-011 FOR MORE INFORMATION.
- CONTROLLED DOORS IN THE ARMORY AREA ARE TO BE CONTROLLED FROM THE PRISON CENTRAL CONTROL ROOM.
- ALL ITEMS LISTED IN GENERAL NOTES ABOVE FOR THE ARMORY AREAS ARE TO BE ROUTED INTO THIS ROOM WHICH CONTAINS EXISTING SECURITY AND ACCESS CONTROL IDFS.
- EXISTING INTERCOM STATION IN PASSAGE SIDE OF NEW SLIDER DOOR IS EXISTING TO REMAIN, RELOCATE AS NECESSARY IF LOCATED IN WALL BEING RENOVATED.
- THESE CARD READERS ARE CARD READER/FINGERPRINT UNITS.

## KEY PLAN

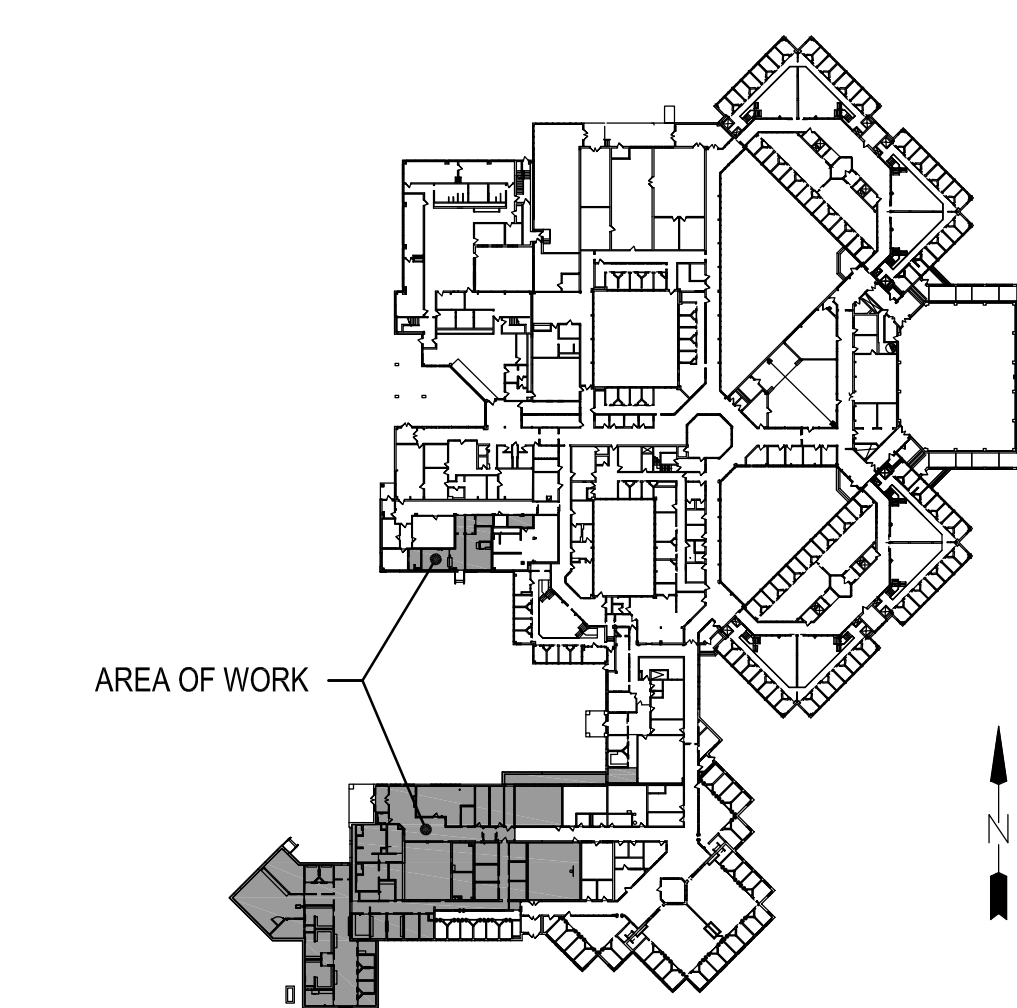

ISSUED FOR BID