

SECOND FLOOR PLAN - AREA E - PIPING
SCALE: 1/8" = 1'-0"

THE HVAC CONTRACTOR SHALL BE RESPONSIBLE FOR COORDINATING ALL ELECTRICAL PANEL LOCATIONS (INSIDE ELECTRICAL AND OUTSIDE ELECTRICAL ROOMS) WITH PIPING AND DUCTWORK LAYOUTS PRIOR TO PIPING AND DUCTWORK INSTALLATION. THE HVAC CONTRACTOR SHALL BE RESPONSIBLE FOR MEETING ALL N.E.C. (NATIONAL ELECTRIC CODE) CLEARANCES BEFORE INSTALLING ANY PIPING AND DUCTWORK. THE HVAC CONTRACTOR SHALL BE RESPONSIBLE FOR ANY AND ALL COSTS RESULTING TO REWORKING (REMOVING AND REINSTALLING) PIPING AND DUCTWORK INSTALLED IN CONFLICT WITH ELECTRICAL PANELS/EQUIPMENT CLEARANCES.

THE HVAC CONTRACTOR WILL BE RESPONSIBLE TO FOLLOW THE PROJECT PHASING SCHEDULE AND ONLY REMOVE SYSTEM COMPONENTS FROM AREAS OF THE PROJECT THAT ARE NO LONGER OCCUPIED AND ARE WITHIN THE CURRENT PHASING LIMITATIONS.

THE HVAC CONTRACTOR WILL NEED TO PROVIDE ALL REQUIRED ISOLATION VALVES AND TEMPORARILY HVAC CONNECTIONS NECESSARY TO KEEP THE EXISTING HEATING/COOLING SYSTEMS FULLY OPERATIONAL WITHIN THE OCCUPIED PORTIONS OF THE BUILDING THROUGHOUT THE ENTIRE LENGTH OF THE PROJECT.

DRAWING NOTES:

- REFER TO DRAWING H-4 FOR HVAC GENERAL PROJECT NOTES.
- PROVIDE REQUIRED SERVICE CLEARANCE FOR ALL HVAC UNITS AS RECOMMENDED BY THE EQUIPMENT MANUFACTURER.
- THE HVAC CONTRACTOR IS RESPONSIBLE FOR ALL CUTTING AND PATCHING REQUIRED TO COMPLETE ALL INDICATED WORK.
- THE HVAC CONTRACTOR IS RESPONSIBLE FOR ALL EXCAVATION AND BACKFILLING NOT INDICATED TO BE PROVIDED BY THE GENERAL CONTRACTOR ELSEWHERE IN THE DOCUMENTS THAT IS REQUIRED TO COMPLETE ALL INDICATED HVAC WORK.
- REFER TO ARCHITECTURAL REFLECTED CEILING PLANS FOR EXACT LOCATIONS OF HVAC CEILING OUTLETS AND OTHER CEILING MOUNTED DEVICES. ANY CEILING REMOVAL REQUIRED FOR WORK TO BE COMPLETED UNDER THIS CONTRACT, THAT IS NOT INDICATED ON THE ARCHITECTURAL PLANS, SHALL BE THE RESPONSIBILITY OF THIS CONTRACTOR. CEILINGS REMOVED BY THIS CONTRACTOR SHALL BE REPLACE AND/OR REPAIRED BY HIM, AS PER SPECIFICATIONS.
- HVAC CONTRACTOR SHALL PROVIDE MANUAL AIR VENTS AT ALL PIPING HIGH POINTS FOR BOTH THE HEATING WATER SYSTEM PIPING AND CHILLED WATER SYSTEM PIPING, TYPICAL THROUGHOUT THE ENTIRE PROJECT.
- OTHER THAN CORRIDORS, ALL OVERHEAD HVAC SYSTEM PIPING MUST BE ROUTED EITHER UP IN BETWEEN BAR JOIST OR THROUGH BAR JOIST WEBBING UNLESS OTHERWISE NOTED.
- PROVIDE ALL REQUIRED TEMPORARY PIPING CONNECTIONS NEEDED TO KEEP EXISTING DUAL TEMPERATURE, CHILLED WATER AND HEATING SYSTEM PIPING LOOPS ACTIVE UNTIL ALL PHASES OF CONSTRUCTION ARE COMPLETE.
- WHERE PIPING CONNECTIONS ARE TEMPORARILY BEING MADE TO EXISTING SYSTEM MAINS, REMOVE EXISTING PIPE INSULATION FROM AREA BEING TAPPED, COMPLETE PIPING CONNECTION THEN RE-INSULATE PIPING PER REQUIREMENTS LISTED IN SPECIFICATIONS.
- PRIOR TO COMPLETION OF FINAL PHASE OF CONSTRUCTION, ALL TEMPORARY PIPING CONNECTIONS AND ASSOCIATED INSULATION, VALVES, HANGERS AND SUPPORTS MUST BE COMPLETELY REMOVE.

KEYED DRAWING NOTES:

- PROVIDE ISOLATION VALVES, STRAINER, CONTROL VALVE AND ALL REQUIRED CONTROLS AND WIRING NEEDED TO RECONNECT EXISTING TERMINAL HEATING EQUIPMENT TO BMS. RE-INSULATE PIPING AS INDICATED IN SPECIFICATIONS. RE-INSTALL EXISTING REFINISHED TERMINAL HEATING EQUIPMENT FRONT COVER PANEL THAT WAS REMOVED AND REFINISHED EARLIER.
- PROVIDE ISOLATION VALVES, STRAINER, CONTROL VALVE AND ALL REQUIRED CONTROLS AND WIRING NEEDED TO RECONNECT EXISTING UNIT HEATER TO BMS. RE-INSULATE PIPING AS INDICATED IN SPECIFICATIONS.
- RL/RS UP TO CU-3
- RL/RS UP TO CU-4
- RL/RS UP TO CU-5

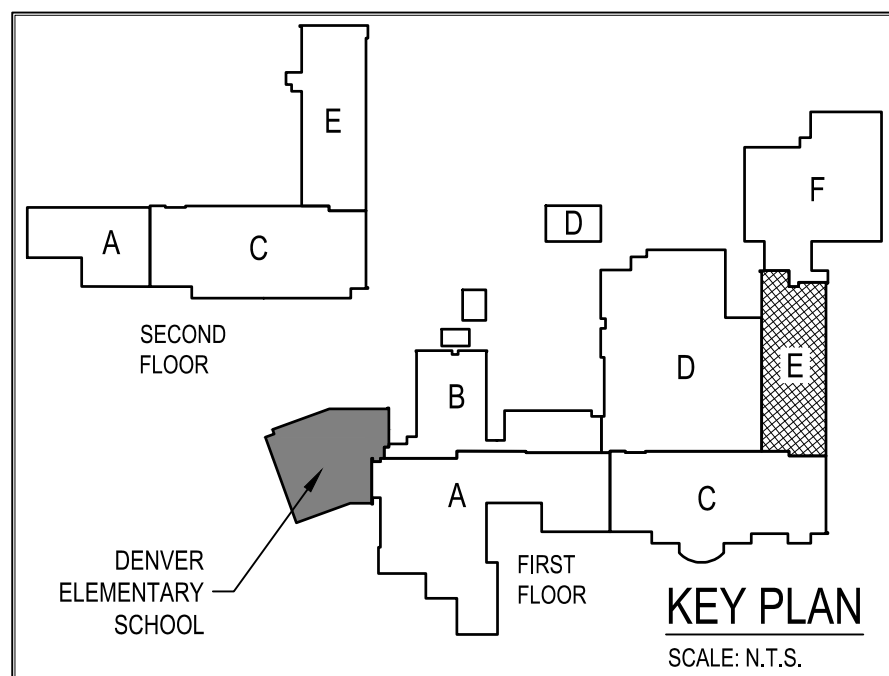

SECOND FLOOR PLAN - AREA E - PIPING
RENOVATIONS TO THE COCALICO MIDDLE SCHOOL
COCALICO SCHOOL DISTRICT
SOUTH 4TH STREET, DENVER BOROUGH, LANCASTER COUNTY PA

ALL DIMENSIONS AND EXISTING CONDITIONS
SHALL BE CHECKED AND VERIFIED
BY THE CONTRACTOR AT THE SITE.

JOB NO.: 23001.00
DRAWN BY: RLC
DATE: 04.12.24

H-E4

CONSOLIDATED
ENGINEERS
1022 Innes Drive
Leesport, PA 19533
Tel: 610/916-1000 Fax: 610/916-1001
Internet: www.consolidatedengineers.com

CIE



AEM ARCHITECTS INC.
3700 PERKINS AVENUE, READING, PA 19606-2785
Phone: 610/793-3220 www.aem-arch.com