

FIRST FLOOR PLAN - UNIT A - HVAC DEMOLITION

SCALE: 1/8" = 1'-0"

KEYED DRAWING NOTES:

- REMOVE EXISTING VERTICAL UNIT VENTILATOR ALL ASSOCIATED DUCTWORK, PIPING, VALVES, INSULATION, HANGERS, SUPPORTS, CONTROLS AND LOW VOLTAGE WIRING IN ITS ENTIRETY BACK TO POINT(S) INDICATED. CAP ANY UNACCESSIBLE CONDENSATE PIPING CONCEALED WITHIN WALL. REMOVE EXTERIOR CONDENSATE PIPING IN ITS ENTIRETY.
- REMOVE EXISTING AIR HANDLING UNIT AND ALL ASSOCIATED DUCTWORK, PIPING, VALVES, INSULATION, DIFFUSERS, GRILLES, DAMPERS, HANGERS, SUPPORTS, CONTROLS AND LOW VOLTAGE WIRING BACK TO POINT(S) INDICATED IN ITS ENTIRETY.
- REMOVE EXISTING EXTERIOR WALL MOUNTED LOUVER, WALL SLEEVE, MOTOR OPERATED DAMPER AND ALL ASSOCIATED DUCTWORK, INSULATION, HANGERS, SUPPORTS, CONTROLS AND LOW VOLTAGE WIRING IN ITS ENTIRETY. COORDINATE WALL REPAIR WITH G.C.
- REMOVE EXISTING FAN COIL AND ALL ASSOCIATED DUCTWORK, PIPING, VALVES, INSULATION, DIFFUSERS, GRILLES, DAMPERS, HANGERS, SUPPORTS, CONTROLS AND LOW VOLTAGE WIRING IN ITS ENTIRETY. COORDINATE WALL REPAIR WITH G.C.
- REMOVE EXISTING ROOFTOP AIR HANDLER, ROOF CURB AND ALL ASSOCIATED DUCTWORK, PIPING, VALVES, INSULATION, DIFFUSERS, GRILLES, DAMPERS, HANGERS, SUPPORTS, DUCT COIL (IF PRESENT), CONTROLS AND LOW VOLTAGE WIRING BACK TO POINT(S) INDICATED IN THEIR ENTIRETY. COORDINATE ROOF REPAIR WITH G.C.
- REMOVE EXISTING DUCTWORK AND ALL ASSOCIATED INSULATION, DIFFUSERS, GRILLES, DAMPERS, HANGERS AND SUPPORTS BACK TO POINT(S) INDICATED IN THEIR ENTIRETY.
- REMOVE EXISTING DUCTWORK AND ALL ASSOCIATED INSULATION, DAMPER(S), HANGERS, SUPPORTS AND CONTROLS AND LOW VOLTAGE WIRING BACK TO POINT(S) INDICATED IN THEIR ENTIRETY.
- REMOVE EXISTING CEILING MOUNTED CABINET EXHAUST FAN AND ALL ASSOCIATED DUCTWORK, INSULATION, GRILLES, DAMPERS, HANGERS, SUPPORTS, CONTROLS AND LOW VOLTAGE WIRING BACK TO POINT(S) INDICATED IN ITS ENTIRETY.
- REMOVE EXISTING ROOF MOUNTED EXHAUST FAN, ROOF CURB AND ALL ASSOCIATED DUCTWORK, INSULATION, GRILLES, DAMPERS, HANGERS, SUPPORTS, CONTROLS AND LOW VOLTAGE WIRING IN ITS ENTIRETY. COORDINATE ROOF REPAIR WITH G.C.
- REMOVE EXISTING ROOF MOUNTED EXHAUST FAN AND ALL ASSOCIATED DUCTWORK, INSULATION, GRILLES, HANGERS, SUPPORTS, CONTROLS AND LOW VOLTAGE WIRING BACK TO POINT(S) INDICATED IN THEIR ENTIRETY. EXISTING ROOF CURB SHALL REMAIN FOR REUSE.
- REMOVE EXISTING ROOF MOUNTED GRAVITY VENTILATOR, ROOF CURB AND ALL ASSOCIATED DUCTWORK, INSULATION, GRILLES, DAMPERS, HANGERS, SUPPORTS, CONTROLS AND LOW VOLTAGE WIRING BACK TO POINT(S) INDICATED IN ITS ENTIRETY. COORDINATE ROOF REPAIR WITH G.C.
- REMOVE EXISTING UNIT HEATER AND ALL ASSOCIATED PIPING, INSULATION, HANGERS, SUPPORTS, CONTROLS AND LOW VOLTAGE WIRING BACK TO POINT(S) INDICATED. BACK TO LAST ACTIVE BRANCH LINE OR MAIN IN THEIR ENTIRETY AND CAP.
- REMOVE EXISTING CABINET HEATER AND ALL ASSOCIATED PIPING, VALVES, INSULATION, HANGERS, SUPPORTS, CONTROLS AND LOW VOLTAGE WIRING BACK TO POINT(S) INDICATED. BACK TO LAST ACTIVE BRANCH LINE OR MAIN IN THEIR ENTIRETY AND CAP.
- REMOVE EXISTING CONVECTOR AND ALL ASSOCIATED PIPING, VALVES, INSULATION, HANGERS, SUPPORTS, CONTROLS AND LOW VOLTAGE WIRING BACK TO POINT(S) INDICATED. BACK TO LAST ACTIVE BRANCH LINE, LAST ACTIVE BRANCH LINE OR MAIN IN THEIR ENTIRETY AND CAP.
- REMOVE EXISTING FINNED TUBE RADIATION AND ALL ASSOCIATED ENCLOSURES, PIPING, VALVES, INSULATION, HANGERS, SUPPORTS, CONTROLS AND LOW VOLTAGE WIRING BACK TO POINT(S). BACK TO LAST ACTIVE BRANCH LINE OR MAIN IN THEIR ENTIRETY AND CAP.
- REMOVE EXISTING DUAL TEMPERATURE SYSTEM PIPING AND ALL ASSOCIATED VALVES, FITTINGS, INSULATION, HANGERS, AND SUPPORTS BACK TO POINT(S) INDICATED IN THEIR ENTIRETY.
- REMOVE EXISTING HEATING SYSTEM PIPING AND ALL ASSOCIATED VALVES, FITTINGS, INSULATION, HANGERS, AND SUPPORTS BACK TO POINT(S) INDICATED IN THEIR ENTIRETY.
- REMOVE EXISTING CHILLED WATER SYSTEM PIPING AND ALL ASSOCIATED VALVES, FITTINGS, INSULATION, HANGERS, AND SUPPORTS IN THEIR ENTIRETY BACK TO POINT(S) INDICATED.
- REMOVE EXISTING UNIT HEATER AND ASSOCIATED PIPING INDICATED TO REMAIN. SHALL REMAIN FOR REUSE. REMOVE EXISTING PIPING INDICATED FOR DEMOLITION. ASSOCIATED ISOLATION VALVES, CONTROL VALVE, CONTROLS AND LOW VOLTAGE WIRING IN THEIR ENTIRETY.
- EXISTING CABINET HEATER AND ASSOCIATED PIPING SHALL REMAIN FOR REUSE. REMOVE EXISTING ISOLATION VALVES, CONTROL VALVE AND ASSOCIATED CONTROLS AND LOW VOLTAGE WIRING IN THEIR ENTIRETY. REMOVE EXISTING FRONT COVER PANEL FOR REFINISHING. CLEARLY TAG EXISTING FRONT COVER PANEL WITH ITS LOCATION FOR EASE OF FUTURE REINSTALLATION. REFER TO BOXED REFINISHING NOTE LISTED ABOVE FOR REFINISHING REQUIREMENTS.
- EXISTING CONVECTOR AND ASSOCIATED PIPING SHALL REMAIN FOR REUSE. REMOVE EXISTING ISOLATION VALVES, CONTROL VALVE AND ASSOCIATED CONTROLS AND LOW VOLTAGE WIRING IN THEIR ENTIRETY. REMOVE EXISTING FRONT COVER PANEL FOR REFINISHING. CLEARLY TAG EXISTING FRONT COVER PANEL WITH ITS LOCATION FOR EASE OF FUTURE REINSTALLATION. REFER TO BOXED REFINISHING NOTE LISTED ABOVE FOR REFINISHING REQUIREMENTS.
- EXISTING ROOF MOUNTED GRAVITY VENTILATOR AND DUCTWORK BACK TO POINT INDICATED SHALL REMAIN FOR REUSE. REMOVE EXISTING MOTOR OPERATED DAMPER, ASSOCIATED CONTROLS AND LOW VOLTAGE WIRING IN THEIR ENTIRETY.
- REMOVE EXISTING GRILLE, ASSOCIATED EXISTING HORIZONTAL DUCTWORK, FIRE DAMPER AND DUCTWORK RISER SHALL REMAIN BACK TO POINT INDICATED FOR REUSE, REFER TO SECTION 'C', SHOWN ON DWG. HD-E2.
- REMOVE EXISTING GRILLE AND ASSOCIATED HORIZONTAL AND VERTICAL DUCTWORK BACK TO POINT INDICATED ON SECTION 'C', SHOWN ON DWG. HD-E2 IN ITS ENTIRETY. REMAINING VERTICAL DUCT DROP SHALL REMAIN FOR REUSE.
- REMOVE EXISTING GRILLE AND ASSOCIATED HORIZONTAL AND VERTICAL DUCTWORK BACK TO POINT INDICATED ON SECTION 'A', SHOWN ON DWG. HD-E1, IN ITS ENTIRETY. REMAINING VERTICAL DUCT RISER SHALL REMAIN FOR REUSE.
- REMOVE EXISTING VERTICAL DUCT DROP BACK TO POINT INDICATED ON SECTION 'B', SHOWN ON DWG. HD-E2 IN ITS ENTIRETY. REMAINING DUCT DROP SHALL REMAIN FOR REUSE.
- EXISTING DUCTWORK SHALL REMAIN AND BE THOROUGHLY CLEANED, REFER TO SPECIFICATIONS FOR REQUIREMENTS.
- EXISTING CEILING MOUNTED AIR DESTRATIFICATION FAN SHALL REMAIN AND BE THOROUGHLY CLEANED.
- REMOVE EXISTING ISOLATION VALVE AND ASSOCIATED INSULATION AS REQUIRED TO REPLACE ISOLATION VALVE.
- REMOVE EXISTING CONDENSATE DRAIN PIPING AND ASSOCIATED INSULATION, HANGERS AND SUPPORTS BACK TO POINT INDICATED IN THEIR ENTIRETY.
- REMOVE EXISTING DIFFUSER OR GRILLE IN ITS ENTIRETY, ASSOCIATED DUCTWORK SHALL REMAIN FOR REUSE.
- EXISTING CEILING MOUNTED EVAPORATOR, EXTERIOR MOUNTED CONDENSING UNIT, REFRIGERANT PIPING AND THERMOSTAT SHALL REMAIN FOR REUSE.
- REMOVE EXISTING DUCT MOUNTED SMOKE DETECTOR AND ALL ASSOCIATED LOW VOLTAGE CONTROL WIRING IN ITS ENTIRETY.
- REMOVE EXISTING RETURN AIR GRILLE AND ASSOCIATED BALANCING DAMPER ASSEMBLY IN ITS ENTIRETY.

GENERAL DEMOLITION NOTES:

- THE HVAC CONTRACTOR SHALL COORDINATE THE SALVAGE AND DISPOSAL OF ALL EQUIPMENT AND MATERIAL WITH THE OWNER. THE HVAC CONTRACTOR SHALL RETURN TO THE OWNER ANY ITEMS NOTED OR NOT NOTED, ON THE DRAWINGS. AT THE OWNERS REQUEST, ALL REMAINING EQUIPMENT AND MATERIAL SHALL BE DISPOSED OF BY THE HVAC CONTRACTOR.
- THE HVAC CONTRACTOR SHALL COORDINATE AND SCHEDULE ALL WORK IN CONJUNCTION WITH THE ARCHITECTURAL DRAWINGS AS REQUIRED TO ACCOMMODATE PROJECT PHASING.
- REFER TO PROJECT PHASING DRAWING(S) AND SCHEDULE. PROVIDE ALL LABOR AND MATERIAL NECESSARY TO ACCOMMODATE PROJECT PHASING.
- ALL PATCHING AND REPAIRING OF SURFACES AND HOLES LEFT OPEN DUE TO DEMOLITION OR REMOVAL OF EXISTING PIPING, DUCTWORK AND EQUIPMENT SHALL BE THE RESPONSIBILITY OF THE HVAC CONTRACTOR. PATCH EXISTING CONSTRUCTION AS REQUIRED TO MATCH ADJACENT SURFACES OR TO RECEIVE NEW FINISHES AS SCHEDULED UNLESS OTHERWISE INDICATED ON THE ARCHITECTURAL DRAWING.
- THE HVAC CONTRACTOR IS RESPONSIBLE FOR ALL CUTTING AND PATCHING REQUIRED TO COMPLETE ALL INDICATED WORK.
- THE HVAC CONTRACTOR IS RESPONSIBLE FOR ALL EXCAVATION AND BACKFILLING NOT INDICATED TO BE PROVIDED BY THE GENERAL CONTRACTOR ELSEWHERE IN THE DOCUMENTS THAT IS REQUIRED TO COMPLETE ALL INDICATED HVAC WORK.
- ALL EXISTING PIPING, DUCTWORK AND EQUIPMENT SHOWN MUST BE VERIFIED IN THE FIELD. ANY HVAC EQUIPMENT NOT SHOWN SHALL BE BROUGHT TO THE ENGINEERS ATTENTION PRIOR TO REMOVAL.
- REMOVE ALL EXISTING CONCRETE EQUIPMENT PADS LOCATED BENEATH ALL DEMOLISHED EQUIPMENT, UNLESS OTHERWISE NOTED.
- ALL SALVAGED EQUIPMENT MUST BE STORED BY THE CONTRACTOR IN A WEATHER TIGHT AND HEATED ENCLOSURE. CAP ALL FITTINGS AND OR EQUIPMENT OPENINGS TO PREVENT DEBRIS FROM ENTERING THE DEVICE WHILE IN STORAGE.
- HVAC CONTRACTOR MUST COORDINATE ROOF MOUNTED EQUIPMENT REMOVAL WITH ROOFING CONTRACTOR. IF HVAC CONTRACTOR CHOOSES TO REMOVE ROOF MOUNTED EQUIPMENT PRIOR TO ROOFING CONTRACTOR BEING READY TO PATCH ROOF, HVAC CONTRACTOR MUST TEMPORARILY COVER REMAINING ROOF CURB WEATHER TIGHT.
- PRIOR TO REMOVAL OF ANY EXISTING HVAC EQUIPMENT THAT CONTAINS REFRIGERANT THE HVAC CONTRACTOR SHALL REMOVE AND RECOVER THE ENTIRE CONTENT OF THE REFRIGERANT AND ALL ASSOCIATED OIL IN THE EXISTING EQUIPMENT. ALL REFRIGERANT/OIL RECOVERY EQUIPMENT IS REQUIRED TO BE CERTIFIED BY AN EPA-APPROVED TESTING ORGANIZATION TO ASSURE THAT THE EQUIPMENT MEETS EPA STANDARDS BASED ON THE TESTING METHOD ESTABLISHED BY ARI STANDARD 740. REMOVAL OF ALL CFC AND HCFC REFRIGERANTS MUST CONFORM TO THE REQUIREMENTS OF THE ENVIRONMENTAL PROTECTION AGENCY. ALL WORK IS TO BE PERFORMED BY AN EPA CERTIFIED TECHNICIAN.

THE DEMOLITION WORK INDICATED IS INTENDED TO ASSIST HVAC CONTRACTOR AND GIVE GENERAL INFORMATION. HVAC CONTRACTOR SHALL BE REQUIRED TO VISIT THE PROJECT SITE PRIOR TO BIDDING TO FULLY ACQUAINT HIMSELF WITH THE EXTENT OF ALL DEMOLITION WORK WHICH IS NECESSARY TO COMPLETE THE ALTERATIONS AND NEW CONSTRUCTION AS DESCRIBED IN THE CONTRACT DOCUMENTS. ALL DEMOLITION WORK REQUIRED SHALL BE INCLUDED IN THE CONTRACT PRICE WHETHER INDICATED ON THE DRAWING OR NOT. HVAC CONTRACTOR WILL NOT BE ENTITLED TO ANY CLAIMS FOR ADDITIONAL COMPENSATION RELATED TO REQUIRED DEMOLITION.

THE HVAC CONTRACTOR WILL BE RESPONSIBLE TO FOLLOW THE PROJECT PHASING SCHEDULE AND ONLY REMOVE SYSTEM COMPONENTS FROM AREAS OF THE PROJECT THAT ARE NO LONGER OCCUPIED AND ARE WITHIN THE CURRENT PHASING LIMITATIONS.

THE HVAC CONTRACTOR WILL NEED TO PROVIDE ALL REQUIRED ISOLATION VALVES AND TEMPORARILY HVAC CONNECTIONS NECESSARY TO KEEP THE EXISTING HEATING/COOLING SYSTEMS FULLY OPERATIONAL WITHIN THE OCCUPIED PORTIONS OF THE BUILDING THROUGHOUT THE ENTIRE LENGTH OF THE PROJECT.

ALL EXISTING RECESSED CABINET HEATERS AND CONNECTORS THAT ARE NOTED TO REMAIN AND ARE TO HAVE THEIR EXISTING FRONT COVER PANEL REFINISHED, MUST BE GENTLY MEDIA BLASTED (AVOIDING PANEL DISTORTION) TO REMOVE EXISTING FINISH ON ALL SURFACES.

PRIME ALL SURFACES OF PANEL IMMEDIATELY AFTER MEDIA BLASTING. THEN POWER COAT ALL SURFACES OF EACH PANEL IN A COLOR SELECTED BY ARCHITECT.

AFTER FINISH HAS THOROUGHLY CURED, WRAP ALL PANELS WITH A PROTECTIVE COVERING AND STORE UNTIL NEEDED FOR REINSTALLATION

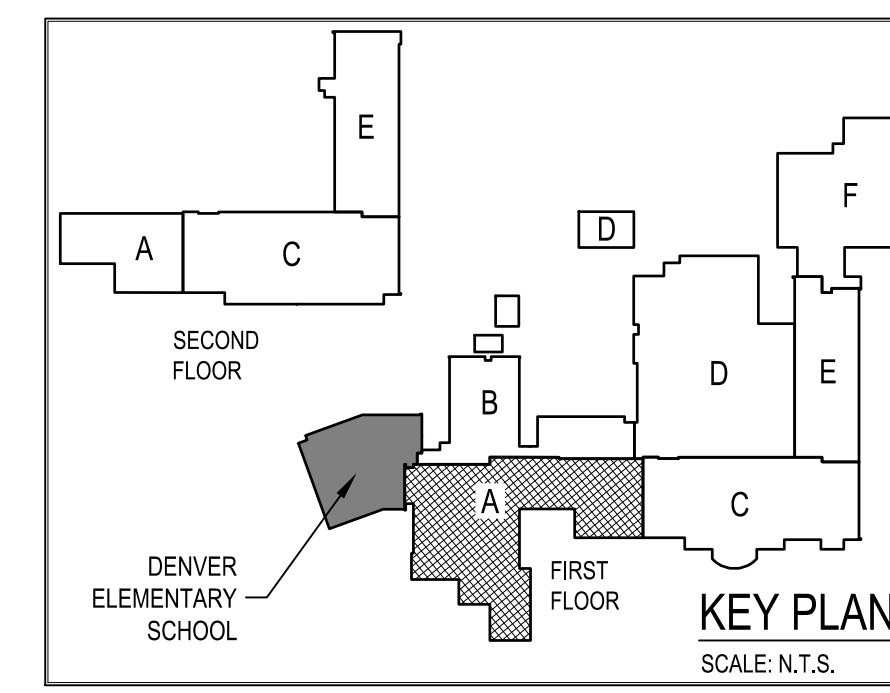

FIRST FLOOR PLAN - UNIT A - HVAC DEMOLITION

RENOVATIONS TO THE COCALICO MIDDLE SCHOOL

COCALICO SCHOOL DISTRICT

SOUTH 4TH STREET, DENVER BOROUGH, LANCASTER COUNTY PA

ALL DIMENSIONS AND EXISTING CONDITIONS SHALL BE CHECKED AND VERIFIED BY THE CONTRACTOR AT THE SITE.

JOB NO.: 23001.00

DRAWN BY: RLC

DATE: 04.12.24

HD-A1

CONSOLIDATED ENGINEERS

1022 Jimes Drive

Leesport, PA 19533

Tel 610-916-1000 Fax 610-916-1001

Internet www.consolidatedengineers.com

CIE

COMMONWEALTH OF PENNSYLVANIA

REGISTERED PROFESSIONAL

ADAM NICHOLAS MOSER

ENGINEER

No. 1078480

AEM ARCHITECTS INC.

3700 PERKOWEN AVENUE, READING, PA 19606-2785

Phone: 610-779-3220 Fax: 610-779-3222

www.aem-arch.com