

FIRST FLOOR PLAN - AREA F - PLUMBING DEMOLITION
SCALE: 1/8" = 1'-0"

THE DEMOLITION WORK INDICATED IS INTENDED TO ASSIST PLUMBING CONTRACTOR AND GIVE GENERAL INFORMATION. PLUMBING CONTRACTOR SHALL BE REQUIRED TO VISIT THE PROJECT SITE PRIOR TO BIDDING TO FULLY ACQUAINT HIMSELF WITH THE EXTENT OF ALL DEMOLITION WORK WHICH IS NECESSARY TO COMPLETE THE ALTERATIONS AND NEW CONSTRUCTION AS DESCRIBED IN THE CONTRACT DOCUMENTS. ALL DEMOLITION WORK REQUIRED SHALL BE INCLUDED IN THE CONTRACT PRICE WHETHER INDICATED ON THE DRAWING OR NOT. PLUMBING CONTRACTOR WILL NOT BE ENTITLED TO ANY CLAIMS FOR ADDITIONAL COMPENSATION RELATED TO REQUIRED DEMOLITION.

THE PLUMBING CONTRACTOR WILL BE RESPONSIBLE TO FOLLOW THE PROJECT PHASING SCHEDULE AND ONLY REMOVE SYSTEM COMPONENTS FROM AREAS OF THE PROJECT THAT ARE NO LONGER OCCUPIED AND ARE WITHIN THE CURRENT PHASING LIMITATIONS.

THE PLUMBING CONTRACTOR WILL NEED TO PROVIDE ALL REQUIRED ISOLATION VALVES AND TEMPORARILY PLUMBING CONNECTIONS NECESSARY TO KEEP THE EXISTING PLUMBING SYSTEMS FULLY OPERATIONAL WITHIN THE OCCUPIED PORTIONS OF THE BUILDING THROUGHOUT THE ENTIRE LENGTH OF THE PROJECT.

GENERAL DEMOLITION NOTES:

1. THE PLUMBING CONTRACTOR SHALL COORDINATE THE SALVAGE AND DISPOSAL OF ALL EQUIPMENT AND MATERIAL WITH THE OWNER. THE PLUMBING CONTRACTOR SHALL RETURN TO THE OWNER ANY ITEMS NOTED OR NOT NOTED, ON THE DRAWINGS, AT THE OWNERS REQUEST. ALL REMAINING EQUIPMENT AND MATERIAL SHALL BE DISPOSED OF BY THE PLUMBING CONTRACTOR.
2. THE CONTRACTOR SHALL COORDINATE AND SCHEDULE ALL WORK IN CONJUNCTION WITH THE ARCHITECTURAL DRAWINGS AS REQUIRED TO ACCOMMODATE PROJECT PHASING.
3. REFER TO PROJECT PHASING DRAWING AND SCHEDULE. PROVIDE ALL LABOR AND MATERIAL NECESSARY TO ACCOMMODATE PROJECT PHASING. IT SHALL BE UNDERSTOOD, ALL EXISTING PLUMBING SYSTEMS SHALL REMAIN FUNCTIONAL AS LONG AS REQUIRED, UNTIL REPLACEMENT WITH NEW OR RE-WORKED AS REQUIRED (SEE NEW WORK PLANS). PC SHALL BE REQUIRED TO PROVIDE TEMPORARY CONNECTIONS TO KEEP SYSTEMS FUNCTIONING PROPERLY.
4. ALL PATCHING AND REPAIRING OF SURFACES AND HOLES LEFT OPEN DUE TO DEMOLITION OR REMOVAL OF EXISTING PIPING AND EQUIPMENT SHALL BE THE RESPONSIBILITY OF THE PLUMBING CONTRACTOR. PATCH EXISTING CONSTRUCTION AS REQUIRED TO MATCH ADJACENT SURFACES OR TO RECEIVE NEW FINISHES AS SCHEDULED.
5. THE PLUMBING CONTRACTOR IS RESPONSIBLE FOR ALL CUTTING, PATCHING AND EXCAVATION AND BACKFILLING WITHIN THE BUILDING REQUIRED TO COMPLETE ALL INDICATED WORK. PC SHALL BE RESPONSIBLE FOR PROTECTION OF EXISTING MATERIAL AND EQUIPMENT TO REMAIN.
6. ALL EXISTING PIPING AND EQUIPMENT SHOWN MUST BE VERIFIED IN THE FIELD. ANY PLUMBING EQUIPMENT NOT SHOWN SHALL BE BROUGHT TO THE ENGINEERS ATTENTION PRIOR TO REMOVAL.
7. REMOVE ALL EXISTING CONCRETE EQUIPMENT PADS WHERE PLUMBING DEMOLITION IS IDENTIFIED UNLESS OTHERWISE NOTED.
8. WHERE BELOW SLAB SANITARY OR STORM LATERALS ARE EITHER CALLED FOR TO BE CAPPED OR ABANDONED, ALLOW FOR AMPLE SPACE TO PROPERLY CAP ENDS OF PIPING.
9. PC SHALL USE GROUND PENETRATING RADAR TO LOCATE EXISTING UNDER-SLAB UTILITIES PRIOR TO SAW CUTTING AND EXCAVATION FOR NEW UNDER FLOOR UTILITIES. P.C. SHALL BE RESPONSIBLE TO REPAIR ANY DAMAGED UTILITIES THAT ARE SEVERED DUE TO MISIDENTIFICATION.

KEYED DEMOLITION NOTES:

1. REMOVE EXISTING PLUMBING FIXTURE, SUPPORTS AND ALL ASSOCIATED EXPOSED AND CONCEALED SUPPLY / DWV PIPING IN ITS ENTIRETY BACK TO MAIN, CAP SANITARY LINE, CONCEALED AND REMOVE VENT STACK UNLESS NOTED TO BE RE-UTILIZED.
2. REMOVE EXISTING FLOOR DRAIN AND DRAIN BODY ASSEMBLY IN ITS ENTIRETY. REMOVE SANITARY LINE BACK TO MAIN AND CAP BELOW FINISHED FLOOR.
3. REMOVE EXISTING VENT, DOMESTIC WATER PIPING, VALVES, HANGERS, SUPPORTS AND INSULATION IN ITS ENTIRETY.
4. EXISTING FLOOR DRAIN SHALL REMAIN.
5. EXISTING WALL HYDRANT TO BE REMOVED.
6. EXISTING PLUMBING FIXTURE, SUPPORTS AND ALL ASSOCIATED EXPOSED AND CONCEALED SUPPLY / DWV SHALL REMAIN.
7. REMOVE PORTION OF EXISTING RWC PIPING AND RECONFIGURE TO ACCOMMODATE RENOVATIONS.
8. REMOVE AND REPLACE INSULATED DOMESTIC WATER PIPING MAINS IN CRAWLSPACE AND WHERE INDICATED, RECONNECT BRANCH SUPPLY PIPING AND RISERS TO ABOVE FLOOR.
9. REMOVE AND REPLACE EXISTING PVC SANITARY / VENT PIPING ABOVE CEILING WITH APPROVED PLENUM MATERIAL. SEE SPEC.
10. PC SHALL LOWER AREA DRAIN TO PROVIDE POSITIVE AREAWAY DRAINAGE.
11. PC SHALL REMOVE EXISTING SPRINKLER SYSTEM SUPPLIED FROM DOMESTIC WATER PIPING. REMOVE EXISTING SPRINKLERS, PIPING, SUPPORTS AND VALVING IN ITS ENTIRETY.
12. REMOVE EXISTING RAIN WATER CONDUCTOR AND ALL ASSOCIATED INSULATION, HANGERS AND SUPPORTS BACK TO POINT INDICATED AND UP TO EXISTING ROOF DRAIN BODY. LEAVE ENOUGH EXISTING PIPE ON ROOF DRAIN AND AT WALL TO PERMIT REATTACHMENT OF NEW PIPING.

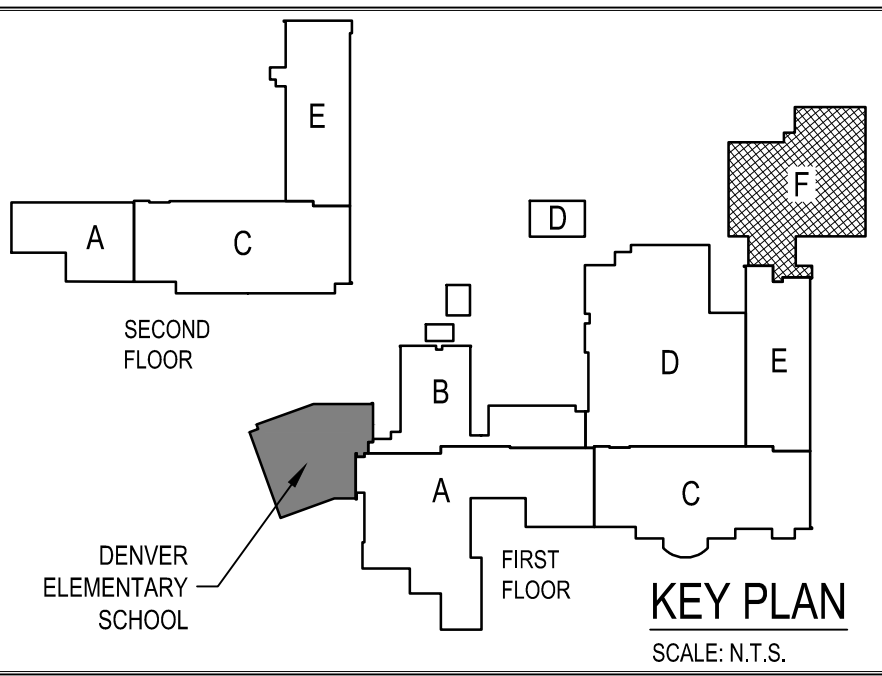

FIRST FLOOR PLAN - AREA F - PLUMBING DEMOLITION
RENOVATIONS TO THE COCALICO MIDDLE SCHOOL
COCALICO SCHOOL DISTRICT
SOUTH 4TH STREET, DENVER BOROUGH, LANCASTER COUNTY PA

ALL DIMENSIONS AND EXISTING CONDITIONS
SHALL BE CHECKED AND VERIFIED
BY THE CONTRACTOR AT THE SITE.

JOB NO.: 23001.00
DRAWN BY: SA
DATE: 04.12.24

PD-F1

AEM ARCHITECTS INC.
3700 PERKINS AVENUE, READING, PA 19606-2785
Phone: 610.779.3220 Fax: 610.779.3220
www.aem-architects.com

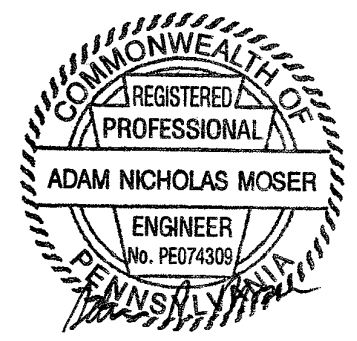

CONSOLIDATED
ENGINEERS
1022 Jimes Drive
Leesport, PA 19533
Tel: 610.916.1600 Fax: 610.916.1601
Internet: www.consolidatedengineers.com

